

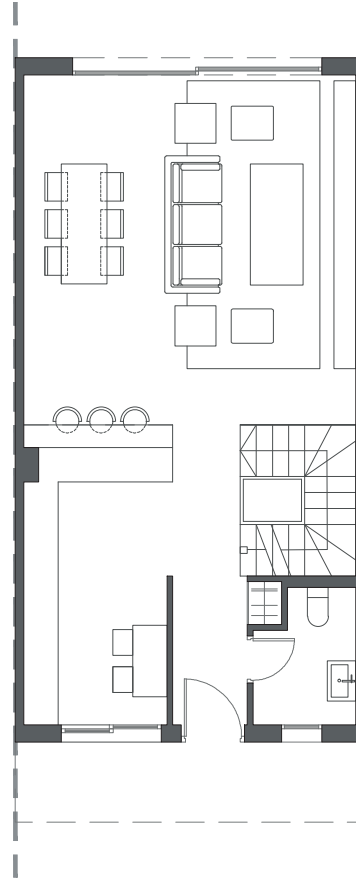

LA VALVEGA
de La Cala



GROUND FLOOR B

HOUSE 22 - BLOCK 3

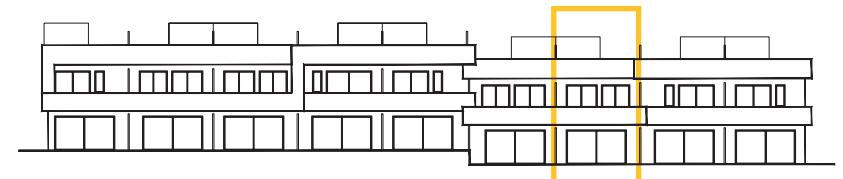
TYPE 1-A - LEFT



Interior view

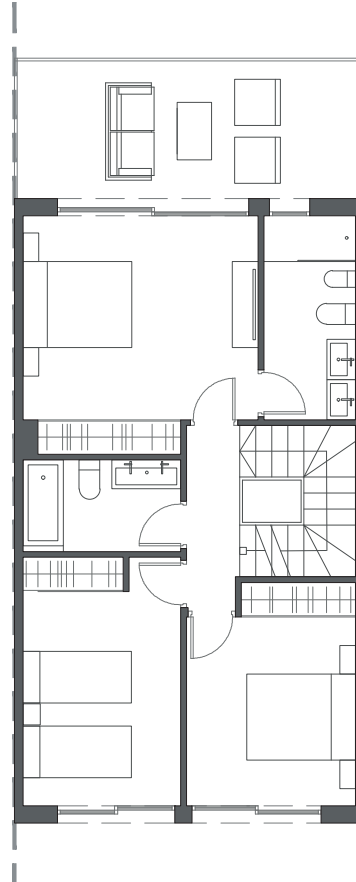

LA VALVEGA
de La Cala



FIRST FLOOR A

HOUSE 22 - BLOCK 3

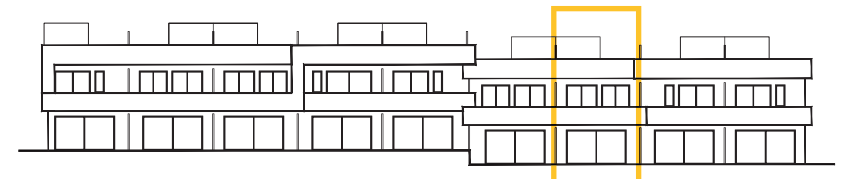
TYPE 1-A - LEFT



Interior view

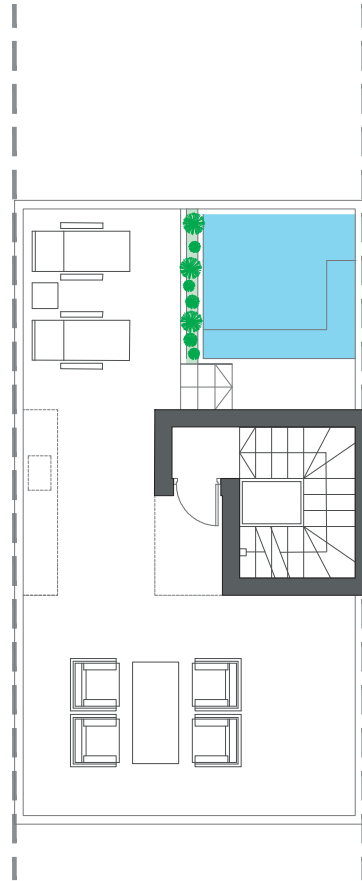

ROOFTOP

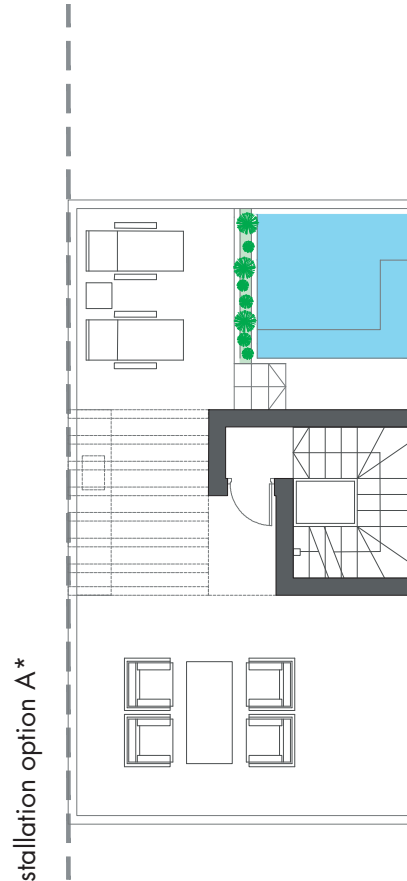

Pre-installation option A*

ROOFTOP

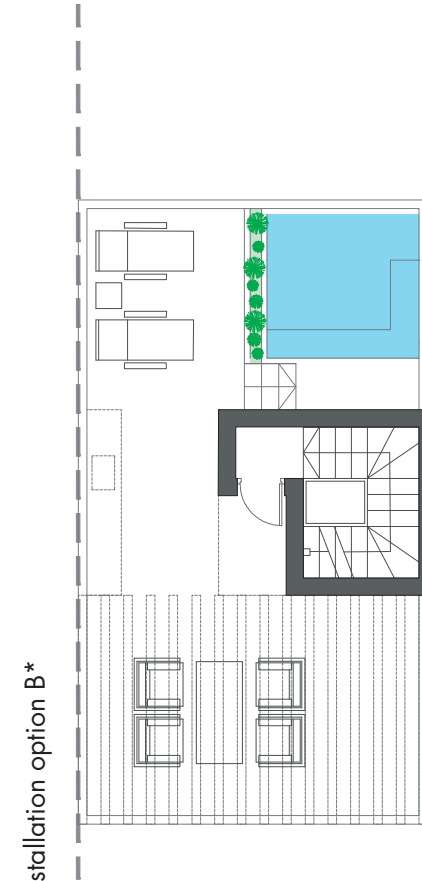

Pre-installation option B*

ROOFTOP

HOUSE 22 - BLOCK 3

TYPE 1-A - LEFT

*These options only include the pre-installation for a pergola, which the client can install in the desired configuration.

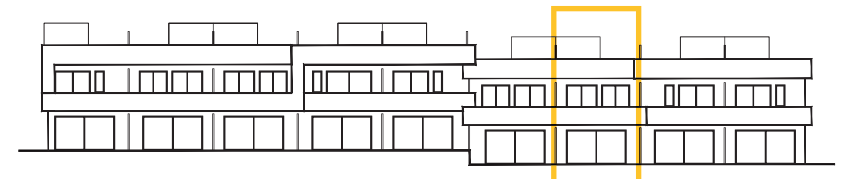

Interior view

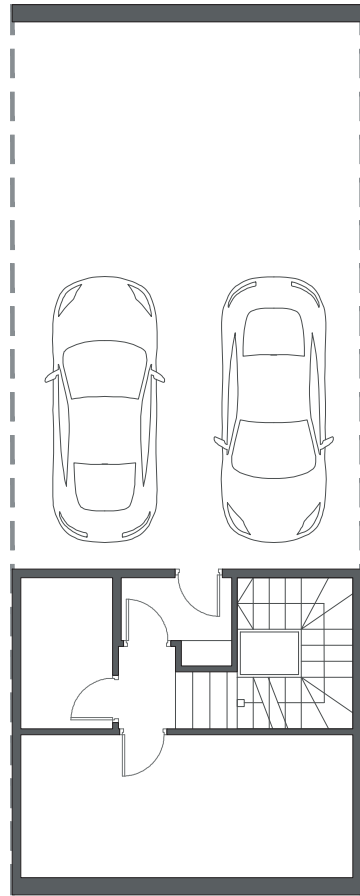

BASEMENT



HOUSE 22 - BLOCK 3

TYPE 1-A - LEFT

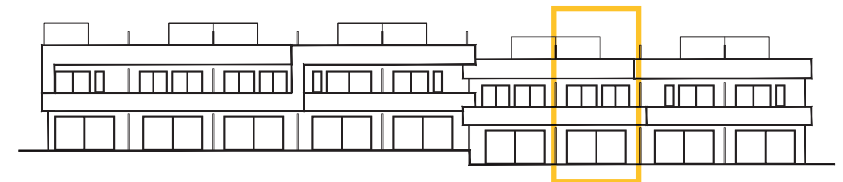

Interior view